

# Small Bay Flex Building For Sale

2180 S. Ivanhoe St., Denver, CO 80222



**For Sale: \$3,950,000** (\$218.61/SF)

## BUILDING OVERVIEW

<b>Building SF:</b>	18,069± SF (per county records)
<b># of Units:</b>	9 Units (15,129 SF Currently Available)
<b>Parking:</b>	26 Spaces (plus on-street parking)
<b>Power:</b>	3-Phase 200 amps per unit (TBV)
<b>Zoning:</b>	I-MX-3
<b>Taxes:</b>	\$75,796.32 (2024 payable in 2025)
<b>Lot Size:</b>	0.85± AC
<b>YOC:</b>	1978 / Renovated 2022
<b>Ceiling Height:</b>	12.5' Clear
<b>HVAC:</b>	15 Units (varying ages)
<b>Roof:</b>	White TPO Membrane (TBV)
<b>Property Mix:</b>	49% Office / 51% Warehouse

## PROPERTY HIGHLIGHTS

### Evans Business Plaza

2180 S. Ivanhoe Street is a great opportunity for an owner user/investor to own a versatile 9-unit flex property along the I-25/ E. Evans corridor. Recently renovated in 2022, this 18,096± SF flex property allows for an owner occupier to benefit from in-place income while running their business. Nine independent small bay units, each with front and rear entry. Each unit has a 10x10 roll-up door, private restroom (in-suite), warehouse heating and cooling, and quality finishes.





www.FullerRE.com

LAND OFFICE INDUSTRIAL RETAIL INVESTMENTS

5300 DTC Pkwy, #100 | Greenwood Village | CO | 80111 | FAX: 303-534-9021

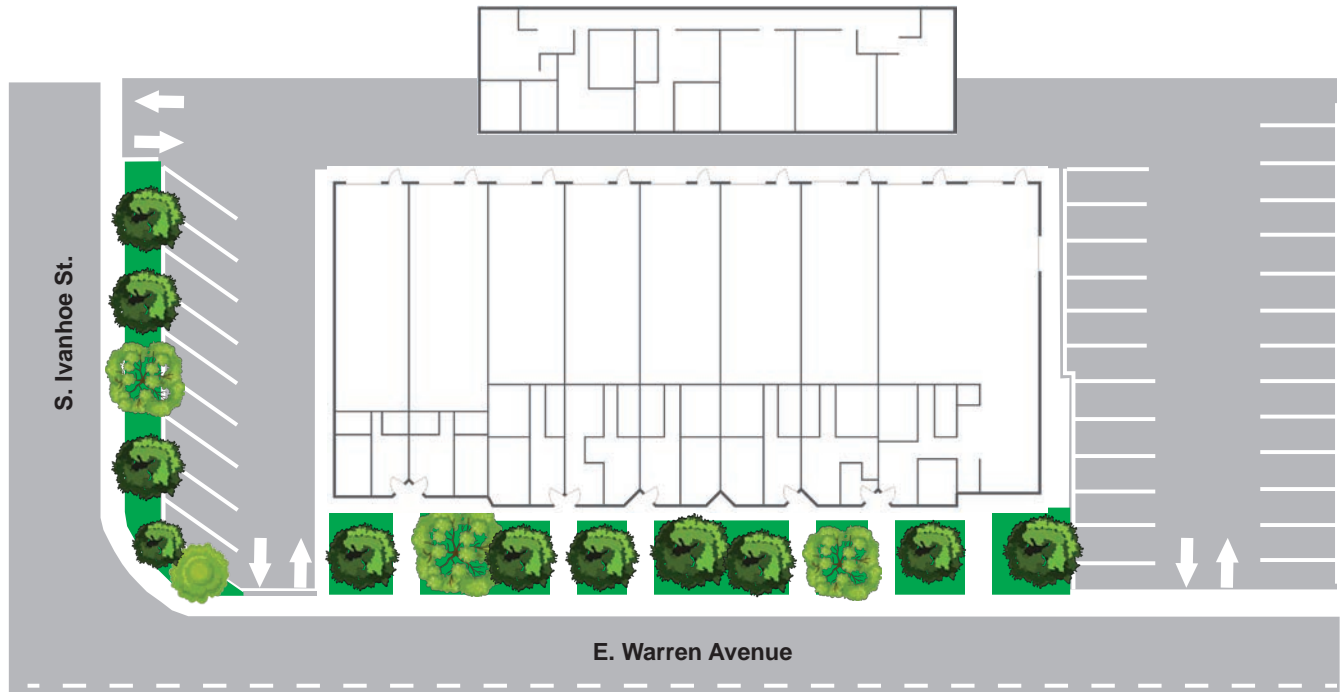
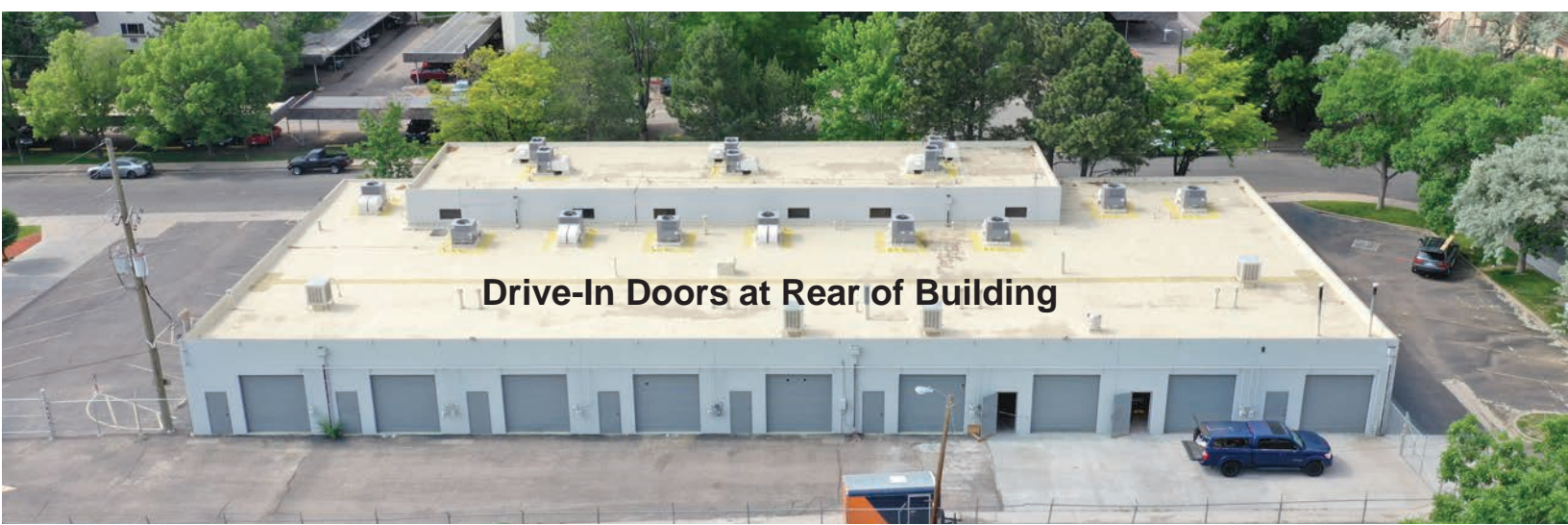

#### DEMOGRAPHICS

1 Mile

3 Miles

5 Miles



Population

19,560

187,904

454,859



Households

8,817

90,584

217,314



Medium Income

\$74,071

\$73,683

\$74,172



Medium Age

38.80

37.80

38.00

The information in this brochure was provided to Fuller Real Estate (FRE) by the owner of the property. FRE has not independently verified this information. Buyers have been advised by FRE to investigate the property including, without limitation, the physical condition of the property, access, availability of utility services, zoning, environmental risks, and soil conditions.