

LAND OFFICE INDUSTRIAL RETAIL INVESTMENTS

Revere Place Office Space For Lease

6551 S. Revere Parkway, Centennial, CO 80111



www.FullerRE.com

Buildout Packages Available



BUILDING FEATURES:

- * 310± SF Suite Available
- * Building Size: 48,314± SF
- * SUPERIOR OWNERSHIP, local management and maintenance
- * YOC: 1982
- * Parking ratio of 3:1,00 SF, all surface, no cost (143 spaces)
- * Common area conference room
- * Numerous nearby restaurant and retail amenities
- * Showers, lockers and Comcast internet to building
- * Easy access off Arapahoe Road
- * **FOR LEASE:** \$20.00/SF full service lease rate

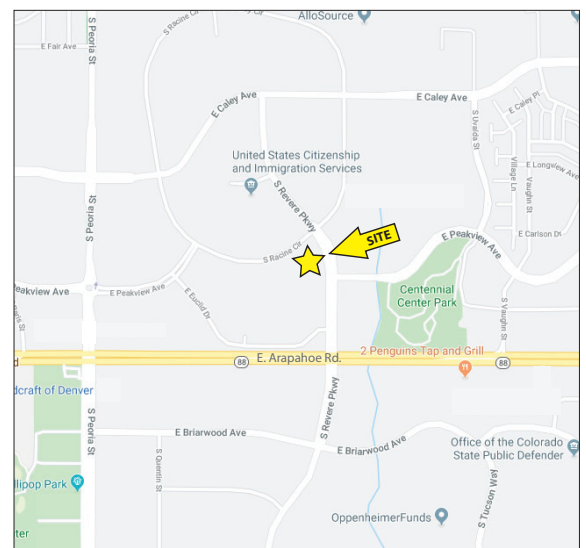

Fuller Real Estate
(303) 534-4822

Brokerage
Disclosure

David Gagliano
720.287.5413 direct
303.818.3618 mobile
DGagliano@FullerRE.com

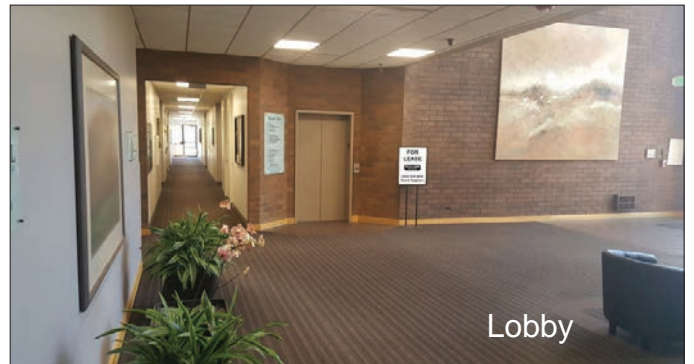
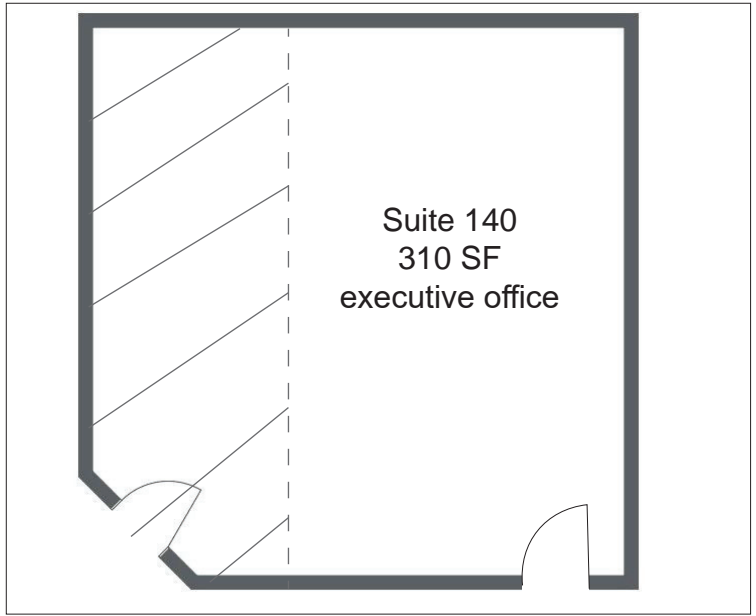

Lobby



Lobby

