

LAND OFFICE INDUSTRIAL RETAIL INVESTMENTS

Highline Canal Office Space For Lease

2250 S. Oneida St., Denver, CO 80224



www.FullerRE.com



CURRENT AVAILABILITY

Suite 100: 3,383± RSF
Suite 315: 1,177± RSF

RENTAL RATE

\$15.00/SF Full Service Gross

PROPERTY INFORMATION:

Building SF:	21,867± Sq.Ft.
Available:	7,250± Sq.Ft.
Lot Size:	0.82 AC
YOC:	1973
Parking:	100 Spaces (3.5/1,000 ratio)

Unique 3-story office building in a great location right off E. Evans Ave. at S. Oneida St. The building offers a convenient SE Denver location, updated common areas, and offers lots of natural light. Backs up to Highline Canal. Available suites vary in size and finishes. Ample on-site parking on a quiet street. Come join lawyers, non-profits, and therapy tenants in this affordable property.

Fuller Real Estate
(303) 534-4822

Brokerage
Disclosure

Travis Wanger
(720) 974-2790 direct
(303) 888-1061 mobile
TWanger@FullerRE.com

Alex Scott
(720) 287-5417 direct
(972) 207-8877 mobile
AScott@FullerRE.com



Floorplans provided as a visual reference only and may not be accurate.

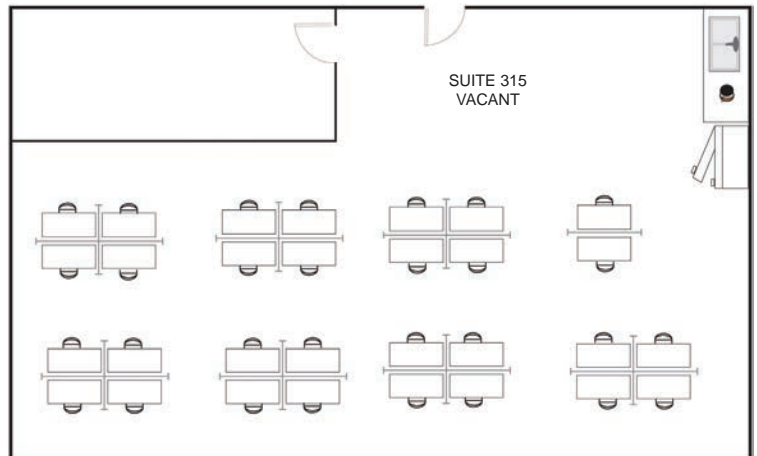

DEMOGRAPHICS	1 Mile	3 Miles	5 Miles
Population	21,651	192,427	442,624
Households	9,922	91,795	207,279
Median HH Income	\$70,594	\$69,411	\$73,535
Median Age	37.20	37.50	38.00
Traffic	34,902 vpd - Evans Ave @ S Oneida St		